

Date Published: 24 May 2016



COUNCIL

18 0000 2016

SUPPLEMENTARY PAPERS

TO: ALL MEMBERS OF THE COUNCIL

The following papers were available at the meeting.

Timothy Wheadon
Chief Executive

| | Page No |
|--|----------------|
| 3. ESTABLISHMENT OF AN APPOINTMENT COMMITTEE | 3 - 4 |
| To establish an Appointment Committee to recruit to the post of Director of Children, Young People and Learning. | |
| 4. AWARD OF SUPPLEMENTARY CAPITAL APPROVAL FOR THE ENHANCEMENT OF CORAL REEF | 5 - 6 |
| To agree a supplementary capital approval in order for the Coral Reef enhancement project to proceed. | |

This page is intentionally left blank

Extraordinary Council

18 May 2016



Agenda Item 3

Establishment of Appointment Committee

Revised Recommendations

The Council is asked to agree:

- 2.1 That a Committee of the Council of five members (4:1), including at least one Member of the Executive (plus up to two substitute members per group) be appointed, with the following terms of reference:

"To interview and appoint on behalf of the Council to the post of Director of Children, Young People and Learning"
- 2.2 That Councillors Dr Barnard, D Birch, Mrs Birch, McLean and Mrs Temperton be confirmed as the nominated members.
- 2.3 That Councillors Leake, McCracken and Virgo be confirmed as the substitute members.

This page is intentionally left blank

Appendix A: New Link and Tower
Existing Flumes with New Flumes 1 and 2

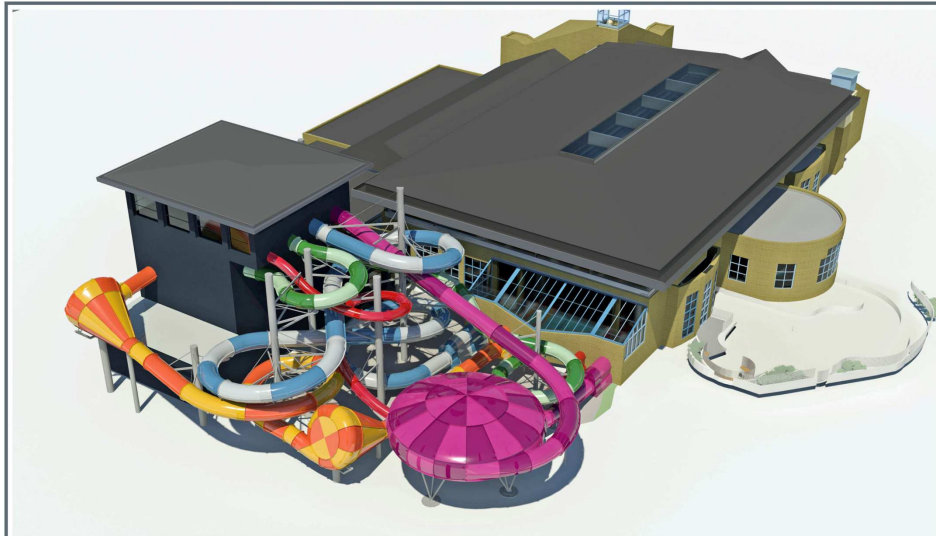
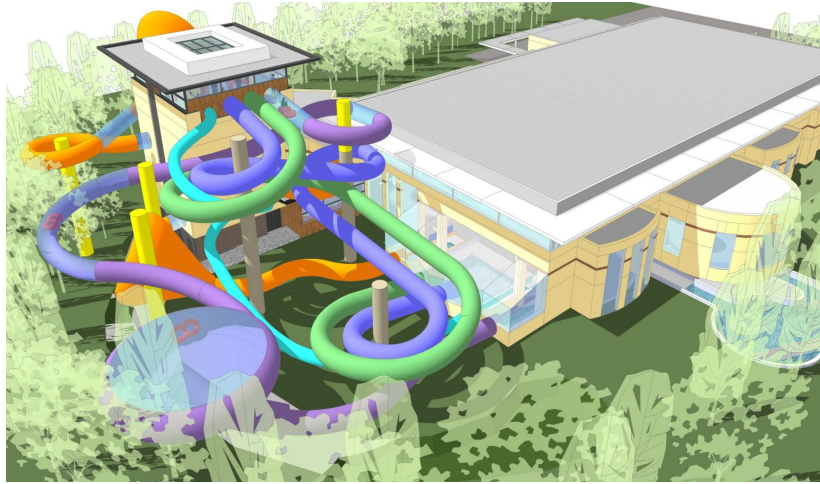

Coral Reef Waterworld 15.103-07
Color Option 3

W A T E R
SLIDES&RIDES
PLAYGROUNDS
SPRAYPARKS
SINCE 1965

This page is intentionally left blank